

Up to 410 watt

WST-MGX-E1 GEMINI Series

Top performance for your rooftop system



DIMENSIONS

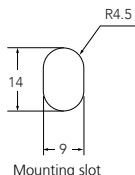
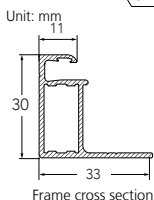
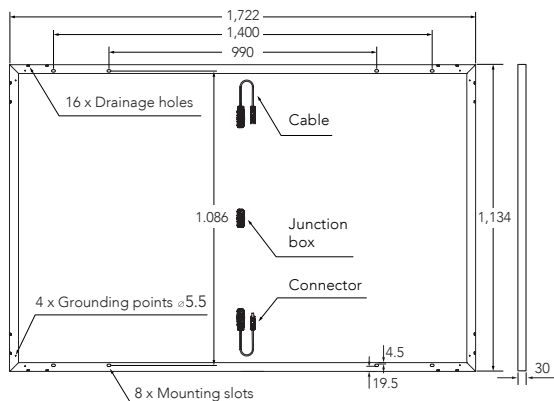

PACKAGING

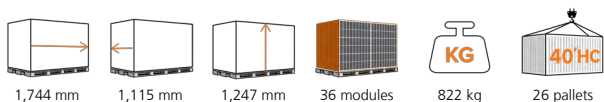

MECHANICAL DATA WINAICO WST-MGX-E1 GEMINI SERIES

Cell	Monocrystalline silicon cells
Quantity of cells	6 strings x 18 cells
Dimensions	1,722 x 1,134 x 30 mm (67.80 x 44.65 x 1.18 in)
Weight	21.6 kg (47.6 lbs)
Glass thickness	3.2 mm (0.13 in)
Frame	Black anodised aluminium
Junction box	IP68
Connector type	PV-HCB40
Module fire performance	Type 4
Fire safety class	C
Cable length (IEC/UL)	1200 mm

GUARANTEE

In accordance with WINAICO's warranty conditions, we grant:

Product warranty
15 years

Performance guarantee
25 years

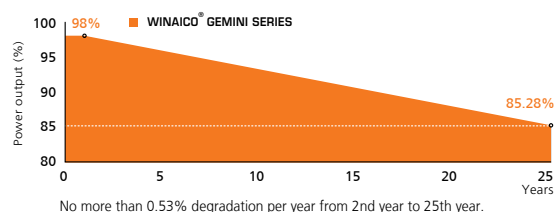

Operating conditions

Operating conditions	WINAICO WST-410MGX-E1
Operating temperature	-40°C to +85°C / -40°F to +185°F
Maximum system voltage IEC/UL	1,500V/1,500V
Maximum series fuse	25A
Maximum design load (push/pull)	3,600 Pa/1,600 Pa
Maximum test load (push/pull)	5,400 Pa/2,400 Pa
Nominal module operating temperature NMOT	41 ± 2°C
Temperature coefficient of P_{MAX}	-0.35 %/°C
Temperature coefficient of V_{OC}	-0.27 %/°C
Temperature coefficient of I_{SC}	0.045 %/°C
Certifications	IEC 61215-1:2016, IEC 61215-2:2016, IEC 61730-1:2016, IEC 61730-2:2016

Electrical data (STC)

Electrical data (STC)	WINAICO WST-410MGX-E1	
Nominal performance P_{MAX}	410	Wp
Voltage at maximum performance V_{MP}	31.43	V
Current at maximum performance I_{MP}	13.05	A
Open circuit voltage V_{OC}	37.40	V
Short circuit current I_{SC}	13.88	A
Module efficiency	21.0	%
Power tolerance	-0/+5	W

Electrical data applies under standard test conditions (STC): solar radiation 1,000 W/m² with light spectrum AM 1.5, with cell temperature 25°C. Measurement tolerance of P_{MAX} at STC: ±3%. Accuracy of other electrical data: ±10%.

Electrical data (NMOT)

Electrical data (NMOT)	WINAICO WST-410MGX-E1	
Nominal performance P_{MAX}	306	Wp
Voltage at maximum performance V_{MP}	29.29	V
Current at maximum performance I_{MP}	10.46	A
Open circuit voltage V_{OC}	35.34	V
Short circuit current I_{SC}	11.26	A

Electrical data applies under Nominal Module Operating Temperature (NMOT), irradiance of 800 W/m², spectrum AM 1.5, ambient temperature 20°C, wind speed 1 m/s.



WINAICO Deutschland GmbH
Tel. + 49 7933 700 300
Fax + 49 7933 700 3010
germany@winaico.com · www.winaico.com
Industriestrasse 68, 97993 Creglingen, GERMANY

WINAICO®
Power to Perform